



Must workshops and mobile service teams do without the power and reliability of large stationary crimpers? UNIFLEX's answer is a definite "no". Our compact, multi-purpose workshop crimpers prove that the advantages of the legendary slide bearing technology can also be used in light-weight, inexpensive equipment that will fit into almost any vehicle and workshop.

The SH 2 series models offer an optimal force-to-weight ratio of 1" 4 SP at a weight of 29 kg, a large opening stroke up to 22 mm (0.87") and a maximum pressing range up to 63 mm (2.48").

New in the range is the SH 2 XL with a larger opening while maintaining full press force. Also new: the QDC grip for quick die changes – compatible with all SH 2 tools, including the new SH 2 XL.



SH 2 XL

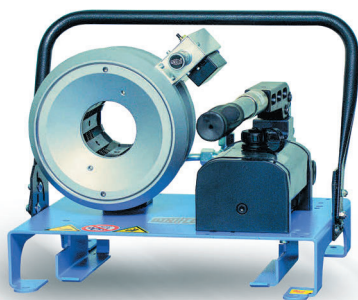

SH 2 M H2



SH 2 A

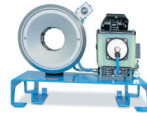

SH 2 M Ecoline

SH 2 M H2

SH 2 P

SH 2 A

SH 2 LA

SH 2 XL

Technical Data	SH 2 M Ecoline	SH 2 M H2	SH 2 P	SH 2 A	SH 2 LA	SH 2 XL
Crimp force (kN/Ton)	900/90	900/90	900/90	900/90	450/45	900/90
No grease: 20% less friction	✓	✓	✓	✓	✓	✓
4-spiral + 1-pc fittings*	1¼"	1¼"	1¼"	1¼"	¾"	1¼"
4-spiral + 2-pc fittings*	1"	1"	1"	1"	⅝"	1"
Industry hose	1¼"	1¼"	1¼"	1¼"	1¼"	1¼"
90° Elbows	1"	1"	1"	1"	1"	1"
Max. Crimp range** (mm/inch)	63 / 2.48	63 / 2.48	63 / 2.48	63 / 2.48	63 / 2.48	63 / 2.48
Opening (mm/inch)	+22 / +0.87	+22 / +0.87	+22 / +0.87	+22 / +0.87	+22 / +0.87	+27 / +1.06
Opening without dies (mm/inch)	77 / 3.03	77 / 3.03	77 / 3.03	77 / 3.03	77 / 3.03	82 / 3.22
Master dies length (mm/inch)	75 / 2.95	75 / 2.95	75 / 2.95	75 / 2.95	75 / 2.95	75 / 2.95
Type of dies	263.2	263.2	263.2	263.2	263.2	263.2
Press path (mm)	8	8	8	8	8	12
Speed (mm/sec)						
Close	-	-	0.9	5.8	2.4	2.7
Crimp	-	-	0.9	0.6	0.2	2.7
Drive	Manual	Manual	Pneumatic ***	1-VAC	1-VAC	12 or 24 V DC or 1 Ph 110/220 V, 50/60 Hz.DC oder 1 Ph 110/220 V, 50/60 Hz.
Oil	0.75 l	0.75 l	2 l	1.5 l	1.5 l	1.5 l
L x W x H (mm)	216 x 165 x 348	500 x 420 x 440	380 x 400 x 310	450 x 450 x 350	450 x 450 x 450	540 x 716 x 562 without power unit
Weight (kg)	29	32	33	41	56	80

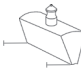
Type of dies	
 263.2-xx-Øxx	
Ø mm	mm
6.8	40
9	75
12	75
14	75
17	75
20	75
24	75
28	75
32	75
36	75
40****	75
44****	75
47****	75

* According to the fitting. ** With master dies. *** 7 bar/98 psi. **** Not suitable for QDC 263.3.

Packages page 28 / Accessories and options page 50

Description

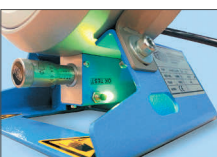

On SH 2 models, an optical signal is given when the crimp measure is reached. The electric and pneumatic variants have an automatic stop function.



Telescopic hand-lever available. Included with SH 2 M machines.



New standard by SH 2 MH and SH 2 M Ecoline with special pump. The low pressure delivery volume is around three times higher than the standard: 32/3 cc instead of 11/3 cc



PUM 0.8/3.2-700 bar. The mobile high pressure unit achieves 700 bar: a real magic box! Not for SH 2 LA and SH 2 XL.

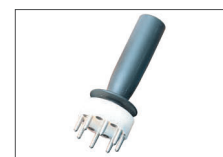

QDC 263.3

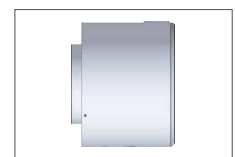

SH = Hollow piston press tool