



Due to their narrow and innovative construction, high level of user friendliness and long service life, the SH 10 i and SH 10 i XL set new standards for quality and cost effectiveness. Their large opening, + 45 mm (+ 1.77") for SH i 10 and +61 mm (+ 2.40") for S 10 i XL, fits industrial hoses with large flanges.

The use of long master dies allows you to crimp 90° elbow fittings up to 2" with the tried and tested greaseless slide bearing technology, which reduces maintenance costs and increases the product quality.



SH 10 i XL IPC



SH 10 i Ecoline



SH 10 i C.2



SH 10 i Ecoline

SH 10 i

SH 10 i XL Ecoline

SH 10 i XL

| Technical Data                 | SH 10 i Ecoline   | SH 10 i           | SH 10 i XL Ecoline | SH 10 i XL        |
|--------------------------------|-------------------|-------------------|--------------------|-------------------|
| Crimp force (kN / Ton)         | 2,800/280         | 2,800/280         | 2,800/280          | 2,800/280         |
| No grease: 20% less friction   | ✓                 | ✓                 | ✓                  | ✓                 |
| Control                        | Control A         | Control C.2       | Control A          | Control C.2       |
| 4/6-spiral + 1-pc fittings*    | 2"                | 2"                | 2"                 | 2"                |
| 4-spiral + 2-pc fittings*      | 2"                | 2"                | 2"                 | 2"                |
| 4/6-spiral + interlock*        | 2"                | 2"                | 2"                 | 2"                |
| Industry hose                  | 4"                | 4"                | 4"                 | 4"                |
| 90° Elbows                     | 2"                | 2"                | 2"                 | 2"                |
| Max. Crimp range (mm/inch)     | 145 / 5.70        | 145 / 5.70        | 145 / 5.70         | 145 / 5.70        |
| Opening (mm/inch)              | +45 / +1.77       | +45 / +1.77       | +61 / +2.40        | +61 / +2.40       |
| Opening without dies (mm/inch) | 190 / 7.48        | 190 / 7.48        | 200 / 7.87         | 200 / 7.87        |
| Master dies length (mm/inch)   | 126 / 4.96        | 126 / 4.96        | 126 / 4.96         | 126 / 4.96        |
| Type of dies                   | 239 - xx/237 L ** | 239 - xx/237 L ** | 239-xx-Ø/237 L **  | 239-xx-Ø/237 L ** |
| Press path (mm)                | 17                | 17                | 17                 | 17                |
| Speed (mm/sec)                 |                   |                   |                    |                   |
| Close                          | 4.8               | 6.1               | 30/6.0             | 30/6.0            |
| Crimp                          | 2.3               | 1.7               | 1.4                | 1.4               |
| Open                           | 7.9               | 10.3              | 30/17              | 30/17             |
| Noise level                    | 70 dBA            | 67 dBA            | 67 dBA             | 70 dBA            |
| Drive                          | 4 kW 3~VAC        | 5.5 kW 3~VAC      | 4 kW 3~VAC         | 5.5 kW 3~VAC      |
| Oil                            | 50 l              | 70 l              | 50 l               | 70 l              |
| L x W x H (mm)                 | 700 x 600 x 845   | 690 x 600 x 1.400 | 700 x 600 x 845    | 690 x 600 x 1,400 |
| Weight (kg)                    | 372               | 390               | 390                | 430               |
| <b>Options</b>                 |                   |                   |                    |                   |
| Control C.2/IPC                | ✓                 | ✓                 | ✓                  | ✓                 |
| 1 Phase                        | ✓                 | ✓                 | ✓                  | ✓                 |
| 12 VDC/24 VDC                  | ✓                 | -                 | ✓                  | -                 |

| Type of dies |     | Type of dies |     |
|--------------|-----|--------------|-----|
| 239-xx-Ø-yy  |     | 237 L        |     |
| Ø mm         | mm  | Ø mm         | mm  |
| 6.8          | 65  | 54           | 118 |
| 9            | 65  | 57           | 118 |
| 10           | 65  | 62           | 118 |
| 12           | 65  | 67           | 118 |
| 14           | 65  | 71           | 118 |
| 16           | 65  | 74           | 118 |
| 17           | 65  | 78           | 118 |
| 19           | 65  | 84           | 118 |
| 20           | 65  | 86           | 118 |
| 22           | 65  | 90           | 118 |
| 24           | 65  | 96           | 118 |
| 26           | 65  | 103          | 118 |
| 28           | 80  | 106          | 126 |
| 30           | 80  | 111          | 126 |
| 31           | 80  | 116          | 126 |
| 32           | 80  | 121          | 126 |
| 34           | 80  | 126          | 126 |
| 36           | 80  | 131          | 126 |
| 38           | 80  | 135          | 126 |
| 39           | 80  | 137          | 126 |
| 40           | 80  |              |     |
| 44           | 80  |              |     |
| 47           | 100 |              |     |
| 50           | 100 |              |     |
| 54           | 100 |              |     |
| 57***        | 100 |              |     |
| 62***        | 100 |              |     |

\* According to the fitting. \*\* Intermediate dies not required. \*\*\* Not suitable for GDC 239.5. Packages page 28 / Accessories and options page 50

## Description

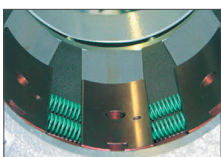

The SH 10 and SH 10 XL-series is fitted with the clean slide bearing technology.

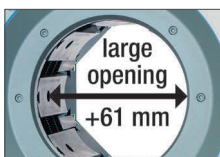

The SH 10 XL offers a large opening travel of up to 61 mm.



ICC – Industrial (hose) Crimp Calculator (only with C.2 and IPC controller)

Automatically calculate your crimp diameter directly from your hose and fitting measurement based on compression. Includes the official agreed, tested and approved industrial hose crimp calculator/Interface with fitting and ferrule data from Mario, PT, Campbell and Dixon.

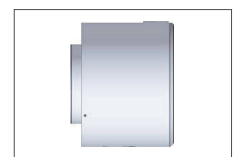

SH = Hollow piston press tool