



Due to their narrow and innovative construction, high level of user friendliness and long service life, the SC 3 and SC 4 set new standards for quality and cost effectiveness. Their compact construction allows for ergonomic working. The use of long master dies allows you to crimp 90° elbow fittings up to 1 ¼" for SC 3 and 1 ½" for SC 4, with the tried and tested greaseless slide bearing technology, which reduces maintenance costs and increases the product quality.

Because the 4-cylinder technology keeps press waste away from the die, UNIFLEX offers a 3-year warranty for the SC 3 and SC 4 series.



SC 3 Ecoline



SC 4 Ecoline



SC 4 C.2



SC 3 Ecoline

SC 4 Ecoline

SC 4 C.2

Technical Data	SC 3 Ecoline	SC 4 Ecoline	SC 4 C.2
Crimp force (kN/Ton)	1,200/120	1,800/180	1,800/180
No grease: 20% less friction	✓	✓	✓
Control	Control A	Control A	Control C.2 + Touch
SAE R 12/4SP* 1 piece fitting	1½"	2"	2"
SAE R 15/4SH* 2 piece fitting	1"	1¼"	1¼"
SAE R 12/4SP* 2 piece fitting	1¼"	2"	2"
Industrial	2"	2"	2"
90° Elbows	1½"	1½"	1½"
Max. Crimp range (mm/inch)	70 / 2.76	70 / 2.76	70 / 2.76
Opening (mm/inch)	+35 / +1.38	+35 / +1.38	+35 / +1.38
Opening without dies (mm/inch)	105 / 4.13	105 / 4.13	105 / 4.13
Master dies length (mm/inch)	100 / 3.94	100 / 3.94	100 / 3.94
Type of dies	239-xx-Ø	239 - xx	239 - xx
Speed (mm/sec)			
Close	4.0	2.7	2.7
Crimp	4.0	2.7	2.7
Open	6.5	4.7	4.7
Noise level	69 dBA	69 dBA	69 dBA
Drive	3 kW 3 VAC	3 kW 3 VAC	3 kW 3 VAC
Oil	35 l	35 l	35 l
L x W x H (mm)	592 x 545 x 672	592 x 545 x 672	720 x 600 x 672
Weight	150 kg	160 kg	203 kg
Options			
12 VDC/24 VDC	✓	✓	-
1 VAC	✓	✓	✓
Control IPC	✓	-	✓

Type of dies	
Ø mm	mm
6.8	65
9	65
10	65
12	65
14	65
16	65
17	65
19	65
20	65
22	65
24	65
26	65
28	80
30	80
31	80
32	80
34	80
36	80
38	80
39	80
40	80
44	80
47	100
50	100
54	100
57	100
62	100

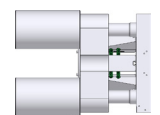

SC = Press tool with Cylinder

* According to the fitting.
Packages page 28 / Accessories and options page 56

Description

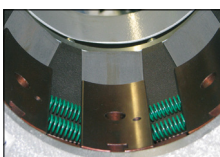

The SC 3- and SC 4-series is fitted with the clean slide bearing technology.



The SC 3- and SC 4-series can be used to crimp short 90° elbow fittings with a long drop. This is impossible for other conventional machines.



With the double pin connection, it is possible to crimp on the front and rear sides.



The 12 VDC/24 VDC units offer space- and weight-saving application options, e.g. for fitting service trucks.
L x W x H (mm)
441 x 291 x 296; 21 kg



PB 239-MD-Ø 70
Closing Pin for Master dies SC 4
(Ø 70 mm)