



With a 370-ton crimping force, the new SC 12 i is the most powerful workshop crimper for R15 industrial hoses up to 3" and high pressure hoses up to 1". With its large opening and a maximum crimping range of up to 139 mm (5.47"), the SC 12 i also crimps 4" Camlock industrial fittings and even 90° fittings with ease.

The compact design allows direct access from all sides, which is particularly important when crimping short workpieces. Three versions of the SC 12 i are available, with a micrometer, Control C.2 or IPC. Like all UNIFLEX crimpers, the SC 12 i features the legendary UNIFLEX slide bearing technology for maximum cleanliness and consistent operations as well as low maintenance requirements and a full 3-year manufacturer's warranty.



SC 12 i C.2



SC 12 i C.2

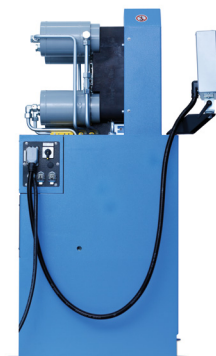

SC 12 i C.2

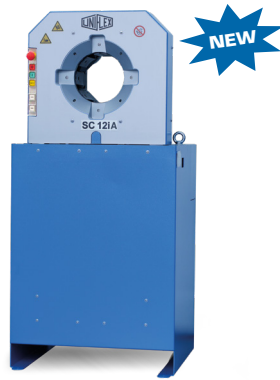

SC 12 i A

SC 12 i C.2

Technical Data	SC 12 i A NEW	SC 12 i C.2 NEW
Crimp force (kN/Ton)	3,700/370	3,700/370
No grease: 20% less friction	✓	✓
Control	Control A	Control C.2
SAE R 15*/4SH 1 piece fitting	3"	3"
4 SH* 2 piece fitting	3"	3"
SAE R 15* 2 piece fitting	3"	3"
Industrial	4"	4"
90° Elbows	2"	2"
Max. Crimp range (mm/inch)	145 / 5.71	145 / 5.71
Opening (mm/inch)	+61 / +2.40	+61 / +2.40
Opening without dies (mm/inch)	206 / 8.11	206 / 8.11
Master dies length (mm/inch)	126 / 4.96	126 / 4.96
Type of dies	239 / 237L	239 / 237L
Speed (mm/sec)		
Close	30/4.9	30/4.9
Crimp	1.4	1.4
Open	30/8.6	30/8.6
Noise level	< 70 dBA	< 70 dBA
Drive	5.5 kW 3 VAC	5.5 kW 3 VAC
Oil	85 L	85 L
L x W x H (mm)	690 x 750 x 1,470	690 x 750 x 1,470
Weight	553 kg	555 kg
Options		
12 VDC/24 VDC	✓	-
1 Phase	✓	-
Control C.2/IPC	✓	✓

Type of dies

239-xx-β-yy	
Ø mm	mm
6.8	65
9	65
10	65
12	65
14	65
16	65
17	65
19	65
20	65
22	65
24	65
26	65
28	80
30	80
31	80
32	80
34	80
36	80
38	80
39	80
40	80
44	80
47	100
50	100
54	100
57	100
62	100

Type of dies

237 L	
Ø mm	mm
54	118
57	118
62	118
67	118
71	118
74	118
78	118
84	118
86	118
90	118
96	118
103	118
106	126
111	126
116	126
121	126
126	126
131	126
135	126
137	126

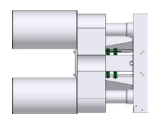

SC = Press tool with Cylinder

* According to the fitting. ** Intermediate dies not required.
 Packages page 28 / Accessories and options page 56

Description



The micrometer allows you to set crimp dimensions to set. (Control A)



The SC 12 series can be used to crimp short 90° elbow fittings with a long drop. This is impossible for other conventional machines.



ICC – Industrial (hose) Crimp Calculator (with C.2 and IPC controller)
 Automatically calculate your crimp diameter directly from your hose and fitting measurement based on compression. Includes the official agreed, tested and approved industrial hose crimp calculator/Interface with fitting and ferrule data from Mario, PT, Campbell and Dixon.